



814 Prolaser® Set-A-Shelf Set & Match® with Laser Line and Stud Finder

Patented



FEATURES

- Horizontal, vertical, or 45° lines
- 2 easy-to-read vials
- "Click-in-place" lock
- "Slide-and-lock" level markers
- Integrated magnetic stud finder

SPECIFICATIONS

- Laser range: up to 20' (6m)
- Laser class: II
- Batteries: 2 AAA (not included)
- Conforms to CE and RoHS safety regulations





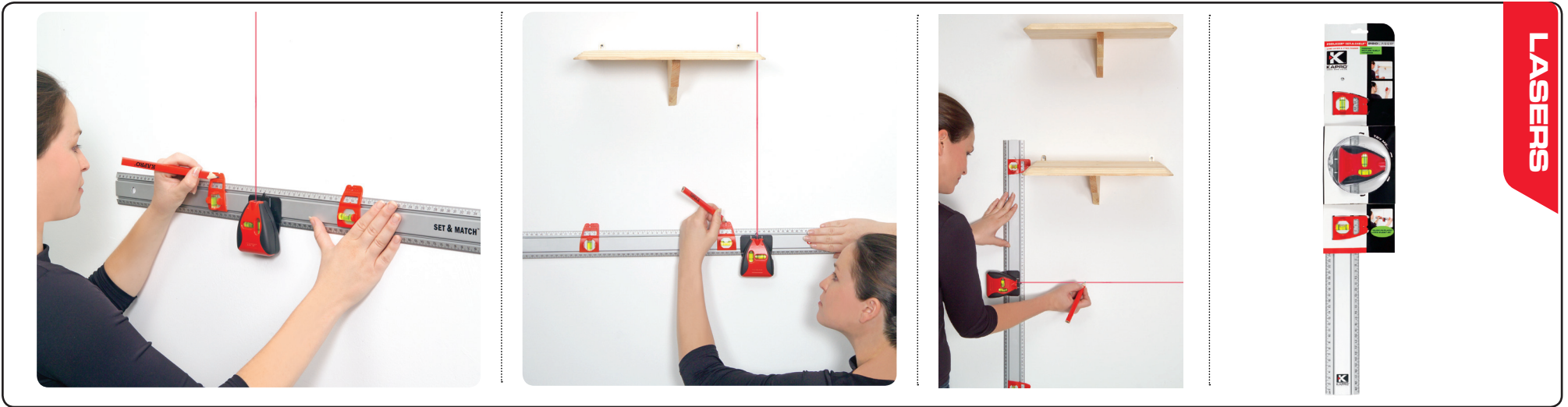



www.kapro.com

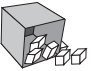

LASERS

814 Prolaser® Set-A-Shelf Set & Match® with Laser Line and Stud Finder

	 unit	 in/cm	 ft ³ /m ³	 lb/kg	 EAN	 UPC
814-24" (60cm)	5 units	25.6" x 6.3" x 5.5" 65 x 16 x 14cm	0.52 ft ³ 0.015 m ³	5.2 lb 2.35 kg	7290100840498	739632086891
814-32" (80cm)	6 units	33.8" x 6.3" x 5.5" 86. x 16 x 14cm	0.68 ft ³ 0.019 m ³	7.9 lb 3.57 kg	7290100840955	739632722393

APPLICATIONS

- Hanging shelves, pictures
- Aligning tiles, borders, moldings, trims
- Building decks



Kapro, the Kapro logo, Prolaser and Set-a-Shelf are trademarks and/or registered trademarks of Kapro Industries Ltd.
www.kapro.com

©2012 Kapro Industries Ltd.
PS 30.055 Version B

